



## COMMERCIAL RETAIL ADVISORS, LLC

5420 E. Broadway Blvd., Suite 200

Tucson, AZ 85711

Phone: 520-290-3200

Fax: 520-751-7465

[www.cradvisorsllc.com](http://www.cradvisorsllc.com)

# AJO CENTER PADS



### Description

**Location:** 2100-2180 E. Ajo Way  
SEC of I-10 & Ajo (aka AZ 86) at Kino Corridor  
Tucson, AZ

**PAD Sizes:** Parcel 1A - ±41,004 SF For Ground Lease or BTS  
Parcel 1B - ±47,535 SF For Ground Lease or BTS  
Parcel 4: ±61,751 SF - For Sale  
Parcel 5: ±38,675 SF - For Sale  
Parcel 2 - For Lease, see separate brochure.

### Demographic Highlights

2021 Estimates	1 MI	3 MI	5 MI
Population	6,778	100,251	259,994
Households	2,059	32,369	91,813
Average HH Income	\$47,813	\$48,333	\$53,134

(Source: ESRI, CCIM Site To Do Business, US Census Bureau 2010)

### Traffic Counts

Ajo Way:	23,617 VPD (2021)
I-10:	70,601 VPD (2020)
Kino:	36,979 VPD (2021)
Total:	131,197 VPD

(Source: Pima Association of Governments and ADOT)

### Property Highlights

- ◆ 2 miles from the University of Arizona, downtown Tucson and the Tucson International Airport.
- ◆ Intersection of three highways, on I-10 off ramp.
- ◆ Next to ±300 acre Kino Sports and Entertainment Complex, currently undergoing a major 90 acre expansion to include an 8,600 SF ice complex, a 130,000 SF field house, and an 8,500 seat stadium. Additional hotels, restaurants, and several multi-family projects are being planned on an adjacent parcel.
- ◆ Next to Banner University Medical Center South Campus
- ◆ Next to ± 350-acre The Bridges master plan development that includes:
  - ◇ ±350,000 SF Tucson Marketplace at The Bridges (up to 1,000,000 SF).
  - ◇ 120,000 SF The Refinery, Phase I of the ±3,000,000 SF UA Tech Park at The Bridges.
  - ◇ ±200,000 SF Geico Regional Headquarters building with ±2,000 employees.
  - ◇ 50,000 SF (up to 150,000 SF) JTED - Joint Technical Educational Facility, with ±25,000 students in first phase.

### A Development By:



W.M. GRACE COMPANIES  
SINCE 1966

### For information, contact:

**Craig Finrock, CCIM, CRX, CLS**  
**Designated Broker**  
[cfinrock@cradvisorsllc.com](mailto:cfinrock@cradvisorsllc.com)

The information contained herein was obtained from third parties, and it has not been independently verified by the real estate brokers. Buyer/tenants should have the experts of their choice inspect the property and verify all information. Real estate brokers are not qualified to act as or select experts with respect to legal, tax, environment, building construction, soils-drainage, or other such matters. Commercial Retail Advisors, LLC represents the owner of the property in any transaction contemplated by this brochure and does not represent the tenant.



# Ajo Center PADs

Tucson, Arizona



COMMERCIAL RETAIL ADVISORS, LLC

## TRADE AERIAL





# Ajo Center PADs

Tucson, Arizona



COMMERCIAL RETAIL ADVISORS, LLC

## PROPOSED SITE PLAN

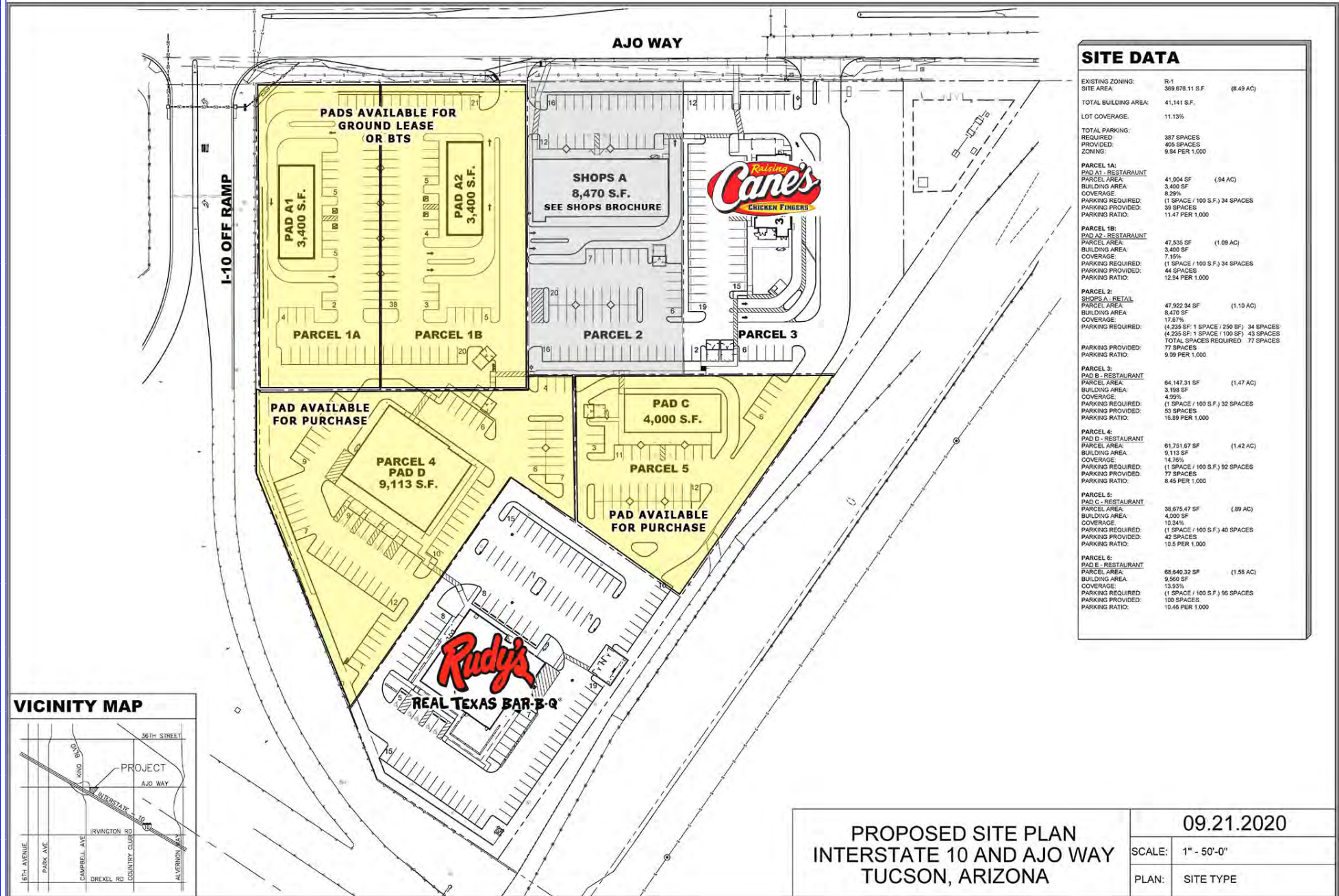



# Ajo Center PADs

Tucson, Arizona



COMMERCIAL RETAIL ADVISORS, LLC

AERIAL - NORTHWEST



AERIAL - EAST





# Ajo Center PADs

Tucson, Arizona



COMMERCIAL RETAIL ADVISORS, LLC

AERIAL - WEST



AERIAL - SOUTHWEST

